



ACCESSIBLEJAPAN
www.accessible-japan.com

脳性麻痺

脳のダメージ
皆はそれぞれ
私: 両手、両足



日常生活

ヘルパー
お出かけ(交通, レストラン など)



来日への道

夢をかけて
情報不足
戻らない(帰化)

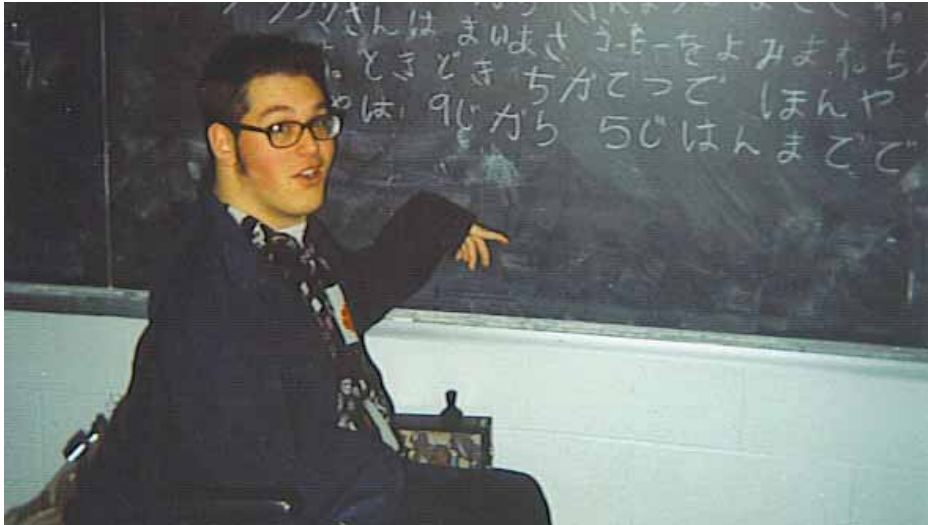

ACCESSIBLEJAPAN
www.accessible-japan.com

恩返し



イメージ 問題

94%

54%





インフラ 問題



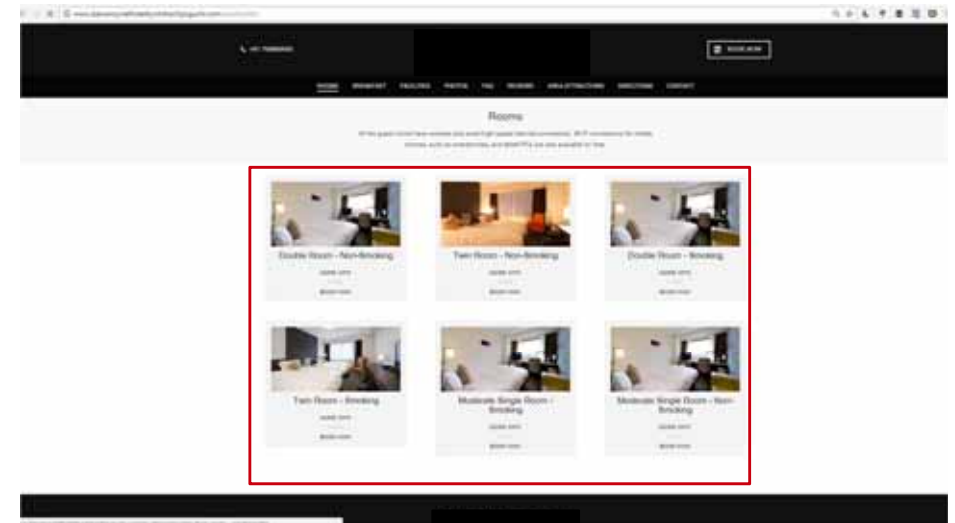
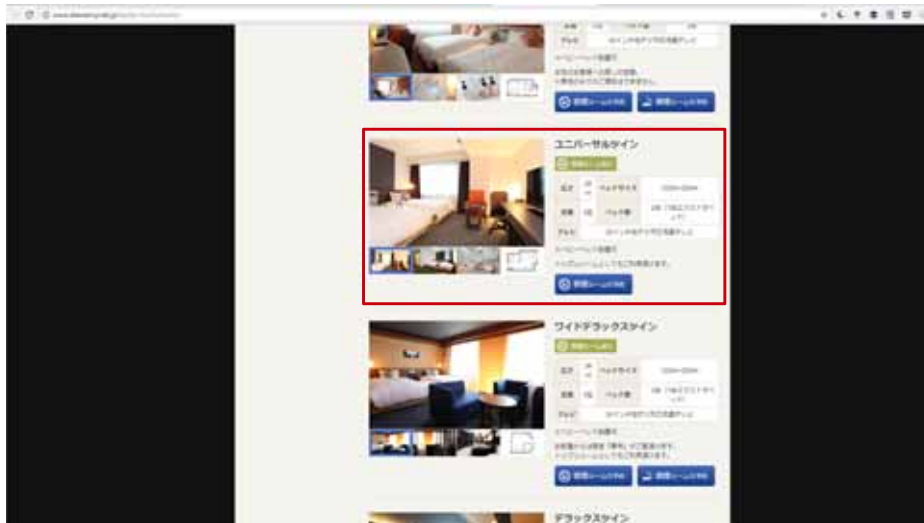

チャンス！

10~13億人 (15%)
 家族やヘルパーを含めると 30億人！
 日本には2020年に29.1% 高齢者



図2 高齢者人口及び割合の推移 (昭和25年~平成52年)

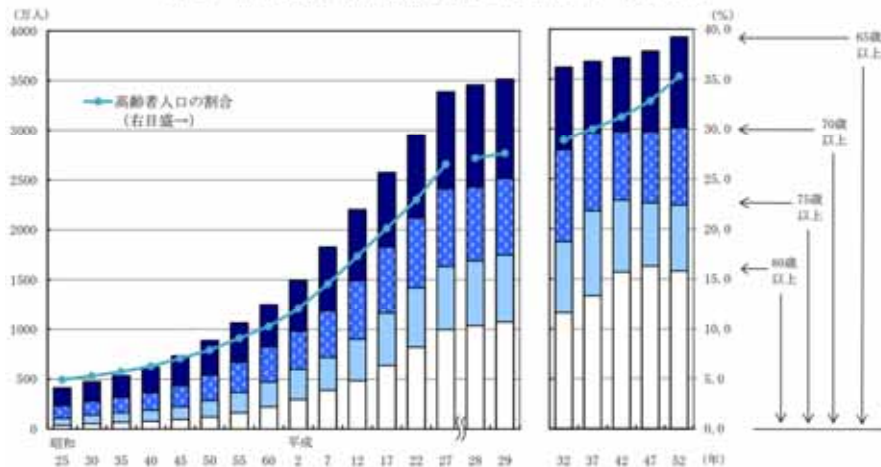

チャンス！

10~13億人 (15%)
 家族やヘルパーを含めると 30億人！
 日本には2020年に29.1% 高齢者
 滞在時間
 グループの人数

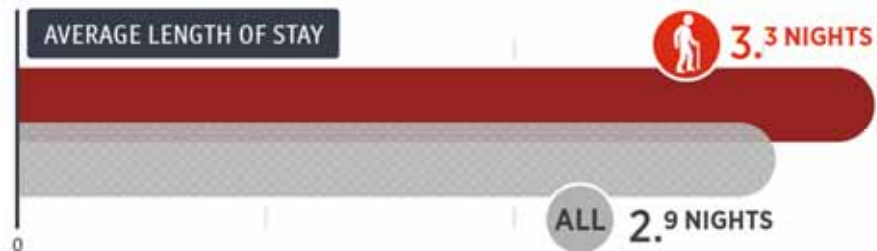

ACCESSIBLEJAPAN
www.accessible-japan.com

チャンス！

10~13億人 (15%)
 家族やヘルパーを含めると 30億人！
 日本には2020年に29.1% 高齢者
 滞在時間
 グループの人数
 ビジネスチャンス

ACCESSIBLEJAPAN
www.accessible-japan.com

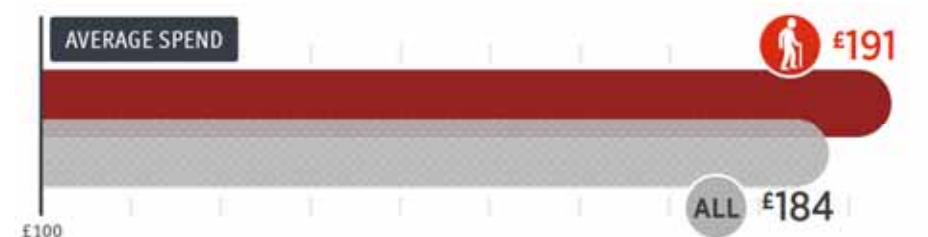

1.7兆円/年



ACCESSIBLEJAPAN About Accessibility Points Attractions Tours Ask Us Blog

to the tracks, but many don't have them and can get stuck. Following as you get closer to the tracks train you may see. Arriving at the area that is accessible, the station staff will go and get a ramp and help you on to the train. Many lines help you on right away but the JR lines seem to have a policy to make you wait until for the next train even if there is one right in front of you.

Riding, Transferring, And Getting Of The Train

Once on the train, you will likely find an area that does not have a bench and you can sit there without worrying that your wheelchair is blocking the floors. This is a great relief when riding during busy hours (6:00-9:00am and 9:00pm-midnight).

ACCESSIBLEJAPAN About Accessibility Hotels Attractions Tours Ask Us Blog

Search Hotels :

Hotel Coco Grand Kitasenju

Category: **Hotel**
 Location: **Kitasenju**
 Number of Rooms: **1**

Hearton Hotel Higashi Shinjuku

Category: **Hotel**
 Location: **Higashi Shinjuku**
 Number of Rooms: **1**



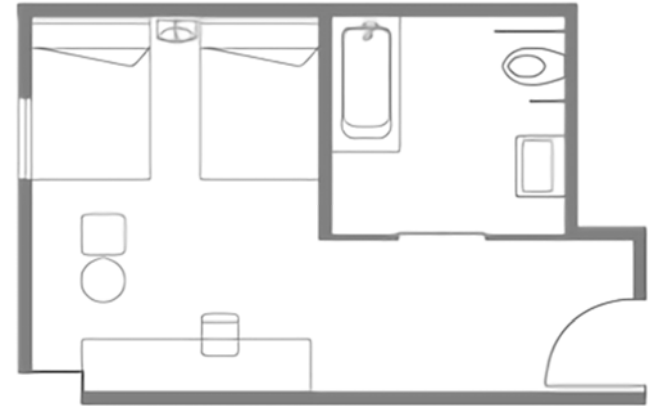

Zojoji Temple

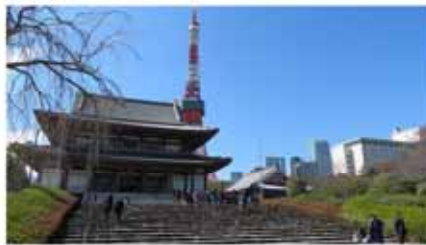

Zojoji Temple is one of Tokyo's most important temples. While it may not look wheelchair accessible, a large part of the temple grounds can be accessed by wheelchair users and those with mobility needs.

BACKGROUND INFORMATION

WANT MORE INFORMATION ON THIS LOCATION?

[ASK A QUESTION](#)

Hotels Near This Attraction



The Strings By InterContinental, Tokyo





ACCESSIBLEJAPAN About Accessibility Hotels Attractions Tour Community Blog

Basic Words

English	Japanese	Pronunciation
Ability	能力	kanari
Physical Disability	身体障害	shinai shobai
Wheelchair	車椅子	wheechair
Wheelchair User	車椅子者	wheechair user
Learning Difficulty	学習障害	shugaku shobai
Autism	自閉症	shimin
Long-term illness	長期病	chogan byou
Multiple Sclerosis (MS)	多発性硬化症	tanpatsu kougaku shou
Stroke	脳卒中	nanbusou
Autism	自閉症	shimin
Deafness	聴覚障害	chougaku shobai
Blindness	視覚障害	shikaku shobai
Intellectual Disability	知的障害	chikaku shobai
Physical Disability	身体障害	shinai shobai
Deaf	耳	mimi
Blind	目	me
Accessibility	アクセシビリティ	akuseshibiriti
Accessibility Plan	アクセシビリティ計画	akuseshibiriti keikaku
Barrier	障害	shobai



ちょっとした工夫で誰かの
人生を変えることができる



ACCESSIBLEJAPAN
www.accessible-japan.com

皆のため

高齢者
ベビーカー
ケガした方

ACCESSIBLEJAPAN
www.accessible-japan.com

日本のおもてなしと工夫で
日本のファンを増やそう！